

# DRAWING FOR CUSTOMER

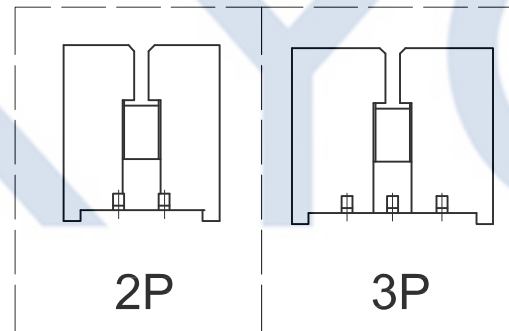
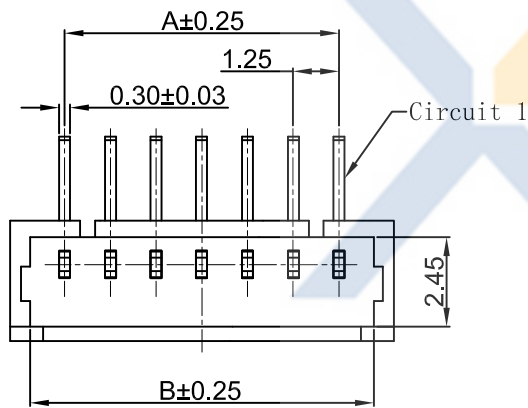
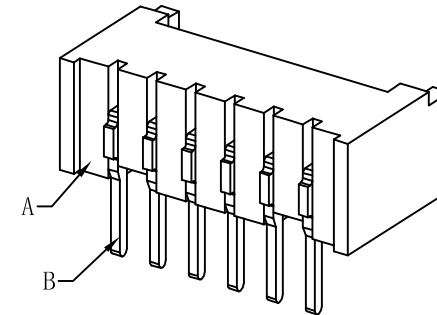
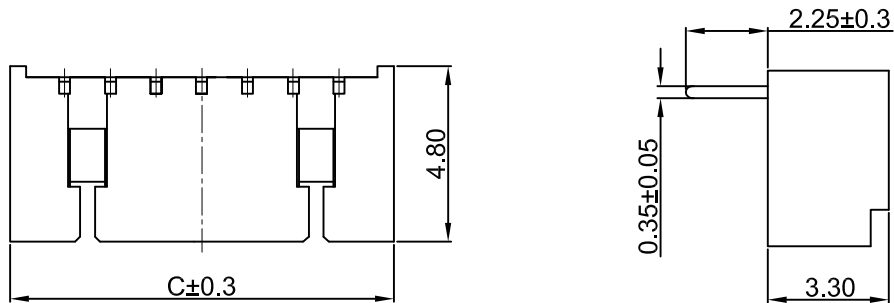

- SPEC.:
- Rated Voltage:125V AC,DC
  - Rated Current:1A AC,DC
  - Withstand Voltage:500V AC/minute
  - Contact Resistance:20mΩ max
  - Insulation Resistance:100MΩ min
  - Temperature Range:-25℃~+105℃

- Material
- Insulator(A):C1-LCP UL94V-0  
Color:BGE-Beige;BK-Black
  - Contact(B):Brass  
Finish:Tin-Plated,over Nickel

Poles	Dimensions (mm)		
	A	B	C
02	1.25	3.20	4.25
03	2.50	4.45	5.50
04	3.75	5.70	6.75
05	5.00	6.95	8.00
06	6.25	8.20	9.25
07	7.50	9.45	10.50
08	8.75	10.70	11.75
09	10.00	11.95	13.00
10	11.25	13.20	14.25
11	12.50	14.45	15.50
12	13.75	15.70	16.75
13	15.00	16.95	18.00
14	16.25	18.20	19.25
15	17.50	19.45	20.50
16	18.75	20.70	21.75

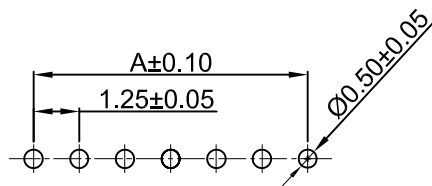

SUGGESTED PCB LAYOUT  
(COMPONENT SIDE)

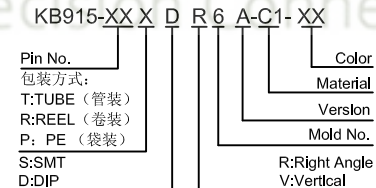

**XYCO** 东莞市轩业电子科技有限公司  
TEL: 0769-8297 9981/2/3 <http://www.XYCO.com.cn>

2013-09-20		A	KB915-XXXDR6A-C1-XX	Devin	TOLERANCE 公差	DRAWING 設計者	Devin	KB915-XXXDR6A-C1-XX		UNIT 單位	mm	PRODUCT NAME 產品名稱	53048 PH1.25mm Wire To Board DIP Right Angle Wafer
DATE 日期	VER 版本	CHANGE HISTORY 變更歷史		CHANGED NAME 修改後料號	DRAWING 變更者	.X=±0.30 .XX=±0.20 .XXX=±0.10	CHECKED 審查	Thomas	PART NO. 料號				
					APPROVED 核准	William	DWG NO. 圖號	PE1904001A					