

DRAWING FOR CUSTOMER

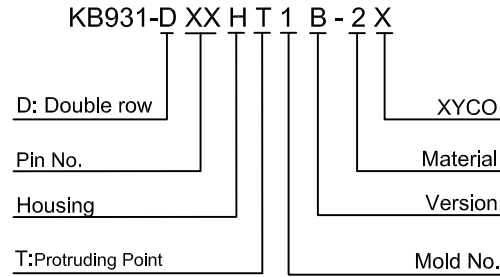

- SPEC.:
- Voltage Rating:250V AC/DC
 - Current Rating:2A AC/DC
 - Dielectric Strength :500V AC/minute
 - Contact Resistance:20mΩ max
 - Insulation Resistance:1000MΩ min
 - Temperature Range:-25°C to+85°C

- Material:
- Insulator:PA66 UL94V-0;
 - Color:Black

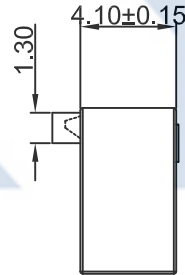
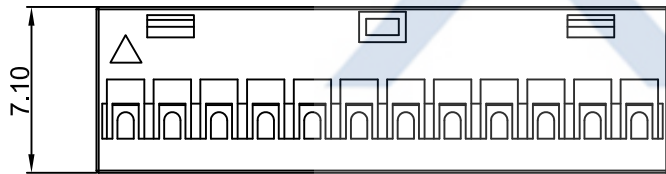
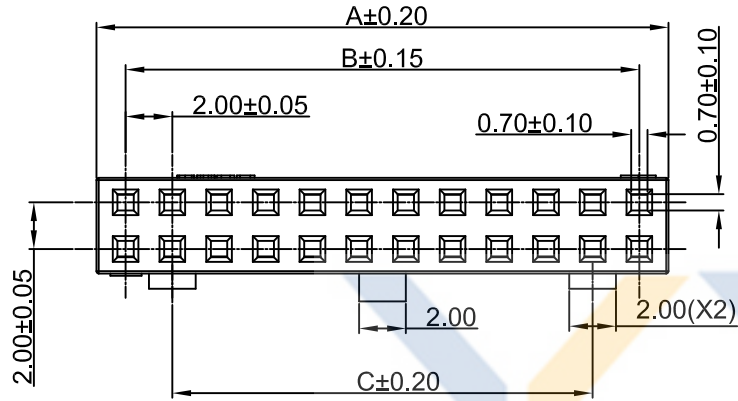

Mark (With Logo:KB931-DXXHT1B-2X)
(Without Logo:KB931-DXXHT1B-2)



Poles	Dimensions(mm)		
	A	B	C
2X04	8.50	6.00	
2X05	10.50	8.00	
2X06	12.50	10.00	
2X07	14.50	12.00	8.00
2X08	16.50	14.00	10.00
2X09	18.50	16.00	12.00
2X10	20.50	18.00	14.00
2X11	22.50	20.00	16.00
2X12	24.50	22.00	18.00
2X13	26.50	24.00	20.00
2X14	28.50	26.00	22.00
2X15	30.50	28.00	24.00
2X16	32.50	30.00	26.00
2X17	34.50	32.00	28.00
2X18	36.50	34.00	30.00
2X19	38.50	36.00	32.00
2X20	40.50	38.00	34.00
2X21	42.50	40.00	36.00
2X22	44.50	42.00	38.00
2X23	46.50	44.00	40.00
2X24	48.50	46.00	42.00
2X25	50.50	48.00	44.00

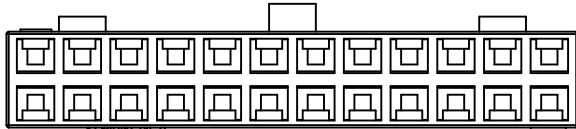

XYCO 东莞市轩业电子科技有限公司
TEL: 0769-8297 9981/2/3 <http://www.XYCO.com.cn>

				TOLERANCE 公差		DRAWING 設計者		Devin		KB931-DXXHT1B-2X		UNIT 單位		mm		PRODUCT NAME 產品名稱		DP2.0 Wire to Board	
2021-03-22	B	增加兩側凸系列		KB931-DXXHT1B-2X	Devin	CHECKED 審查		Thomas		PART NO. 料號						Housing With Protruding Point			
DATE 日期	VER 版本	CHANGE HISTORY 變更歷史		CHANGED NAME 修改後料號	DRAWING 變更者	APPROVED 核准		William		DWG NO. 圖號		PE21032201A							
1	2	3		4		5		6		7		8		9					