

# DRAWING FOR CUSTOMER

- SPEC.:
- Rated Voltage:600V AC,DC
  - Rated Current:9A AC,DC
  - Withstand Voltage:1500V AC/minute
  - Insulation Resistance:1000MΩ min
  - Contant Resistance:20mΩ Max.
  - Temperature Range:-25℃~+85℃

- Notes:
- Material:Nylon66 UL94-V2
  - Color:WH(White),BK(Black)

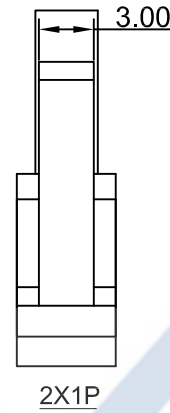
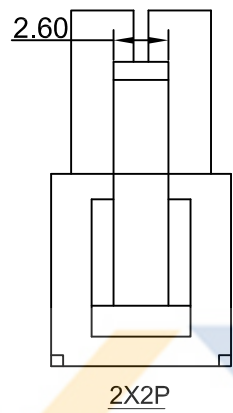
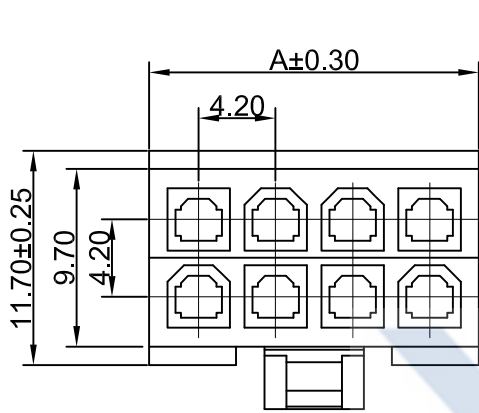

KB970-D XX H L 5 A -XX

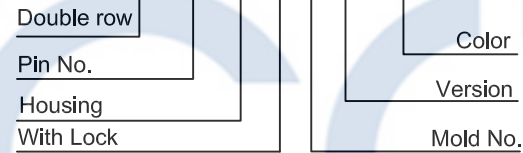

Poles	Dimensions	
	A	B
2*1	5.50	—
2*2	9.70	4.20
2*3	13.90	8.40
2*4	18.10	12.60
2*5	22.30	16.80
2*6	26.50	21.00
2*7	30.70	25.20
2*8	34.90	29.40
2*9	39.10	33.60
2*10	43.30	37.80
2*11	47.50	42.00
2*12	51.70	46.20

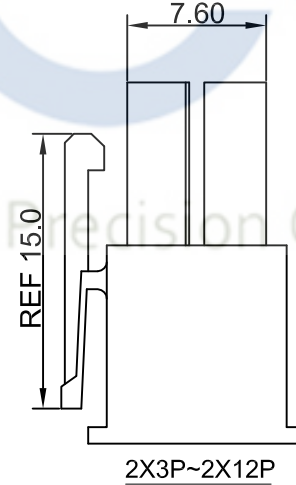
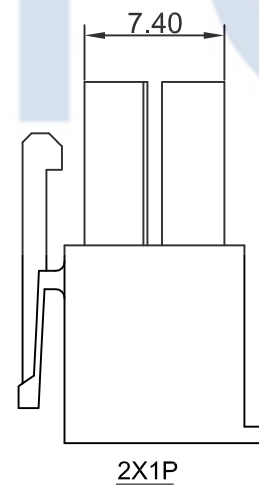
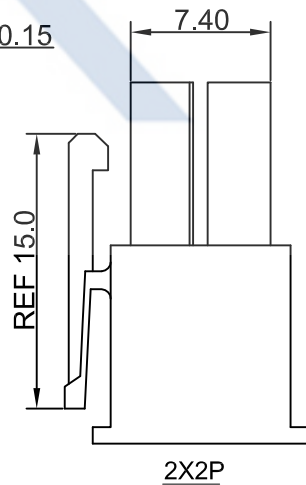
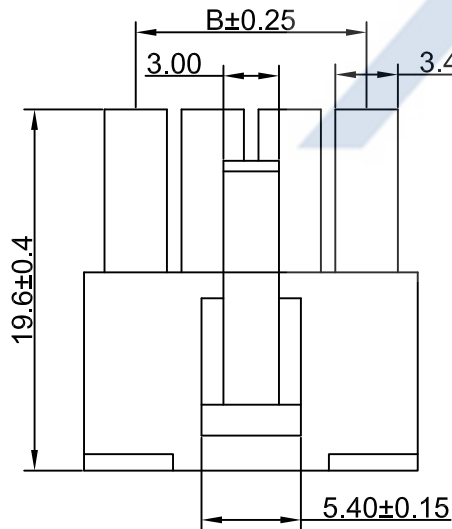

## XYCO PRECISION CONNECTORS

TEL: 0769-8297 9981/2/3 <http://www.XYCO.com.cn>

2013-07-30		A	KB970-DXXHL5A-XX		John	TOLERANCE 公差		DRAWING 设计者		John		KB970-DXXHL5A-XX	
DATE 日期	VER 版本	CHANGE HISTORY 变更历史	CHANGED NAME 修改后料號	DRAWING 变更者	John	.X=±0.30 .XX=±0.20 .XXX=±0.10	CHECKED 审查	THOMAS	PART NO. 料号	UNIT 单位	mm	PRODUCT NAME 产品名称	MOLEX 4.2mm Double Row Housing with lock-Male
					William		APPROVED 核准	WILLIAM	DWG NO. 图号	PE1811011A			

UNIT 单位	mm	PRODUCT NAME 产品名称	MOLEX 4.2mm Double Row Housing with lock-Male
------------	----	----------------------	--